

Fact Sheet

Wyndham Peachtree Conference Center

WYNDHAM PEACHTREE CONFERENCE CENTER

- Landmark Meetings Destination
- 18 Miles from Hartsfield Jackson International Airport
- 6 Miles from Falcon Field Airport
- Member, International Association of Conference Centers
- First IACC Approved Conference Center in Georgia – Opened in 1984
- 30 Miles from Downtown Atlanta

ACCOMMODATIONS

- 250 Guest Rooms & Suites
- Panoramic Forest Views
- Private Deck or Terrace
- Down Comforter & 300 Thread Count Sheets
- Wolfgang Puck Coffee/Tea Maker
- True Blue® Spa Amenities by Bath & Body Works®
- Work Desk with Lamp
- High Speed Wired/Wireless Internet Access
- Herman Miller Aeron® Ergonomic Work Chair
- Dual-Line Cordless Speaker Phone
- Color Cable Television
- AM/FM Clock Radio with MP3 Docking Station
- Wyndham ClearAirSM Rooms with PURE System

MEETINGS & EVENTS

- IACC Certified Conference Center
- Over 26,000 Sq. Ft. of Function Space
- 5,400 Sq. Ft. Grand Ballroom
- 230-Seat Caledonian Amphitheater
- Outdoor Options (2 Courtyards)
- 26 Function Rooms
- Events up to 600 Guests
- Social Events & Weddings
- Dedicated Conference Planner
- Full Service Catering Featuring Farm to the Table Organic Cuisine
- Herman Miller Aeron® Chairs in All Function Space
- Complete Meeting Packages
- Clear AirSM Meeting Environment

TECHNOLOGY & SERVICES

- DS3 Wired & Wireless Internet Access Throughout Hotel
- On-Site Audiovisual
- Business Center/Services
- On-Site Technology Manager
- 1,500 Sq. Ft. Business Center with 14 Workstations – Open 24-Hours
- Elegant Catering
- In-House Inventive Meetings Team for Teambuilding & Creative Meetings
- In-House Transportation Department Providing Local Area & Airport Transportation

RECREATION

- Indoor & Outdoor Pools/Whirlpools
- 10,000 Sq. Ft. Executive Fitness Center with Saunas
- Tennis Courts
- Racquetball & Volleyball Courts
- 100 Miles of Biking & Hiking Trails
- Wii™ Located in the Lounge
- Over 100 Holes of Championship Golf
- Frederick J. Brown Amphitheater
- Atlanta Motor Speedway®
- World-Class Shopping & Historic Attractions
- Downtown Atlanta's Entertainment & Nightlife

DINING

- Terrace Restaurant
- Wynner's Sports Bar & Lounge
- Taste of Tuscany Room
- In-Room Dining



2443 Highway 54 W, Peachtree City, Georgia 30269
Phone: 770-486-3309 Fax: 770-487-5190 Url: WYNDHAMPC.COM

Welcome to the Wyndham Peachtree Conference Center

Success is guaranteed when ideas are given a little room to grow, and there is a world of inspiring space at the Wyndham Peachtree Conference Center. Set 30 minutes outside downtown Atlanta among 19 acres of lush forests, our **IACC-approved** facility is a landmark destination for any event or occasion.

Accommodations are richly appointed and high tech, offering everything from our **Clear AirSM** program for a healthful stay to wired and wireless Internet access. Taste the best of the South in our restaurants, or arrange a private banquet in one of our dining rooms. Between meetings, you will discover how relaxing business travel can be. Choose from tennis, golf, racquetball or volleyball, or gather your group for a stroll through our wooded trails. The 10,000-square-foot **Executive Fitness Center** is equipped with the latest workout machines. We also have indoor and outdoor pools to help you relax and unwind. Our concierge will work hard to make your stay a memorable one.

The Wyndham Peachtree Conference Center was built for successful functions. There are 26 rooms, each equipped with Herman Miller ergonomic desk chairs and the latest technology. From our ballrooms to our amphitheater, you have nothing but choices. Even the catering and hospitality are steeped in Southern warmth. Helping you create exceptional events is what we do best at Wyndham.

Peachtree City is a lush and beautiful setting that welcomes groups with open arms. It is the perfect alternative to the bustling Atlanta revealing the long forgotten charms of the true South. Peachtree City Georgia ranks amongst the top ten Best Places to Live for the past ten years as cited in CNN Money Magazine. Featuring over 100 holes of championship golf, three sparkling lakes and a variety of outdoor concert venues and recreation, this quaint city is linked by over 100 miles of golf carts paths and naturally the home to over 20,000 golf carts. **Teambuilding** opportunities abound including the Amazing Race on golf carts, Dragon Boat Racing in Lake Peachtree and creative culinary challenges. Yet with Atlanta only 30 minutes away, diverse delights await you.

We are conveniently located just 18 miles from Hartsfield-Jackson Atlanta International Airport (ATL), the busiest airport in the world, served by more than 20 passenger airlines. Our in-house transportation team will whisk your attendees to and from the airport and around the Peachtree City area in style.

We appreciate your consideration of our venue and will work hard to help you achieve your goals. From the Complete Meeting Package to our Farm to Table Cuisine executed by IACC's 2010 Copper Skillet Champion Chef, every detail has been designed to enhance your success. Here outside the city, you can hear yourself think. We listen.



Function Space

Wyndham Peachtree Conference Center

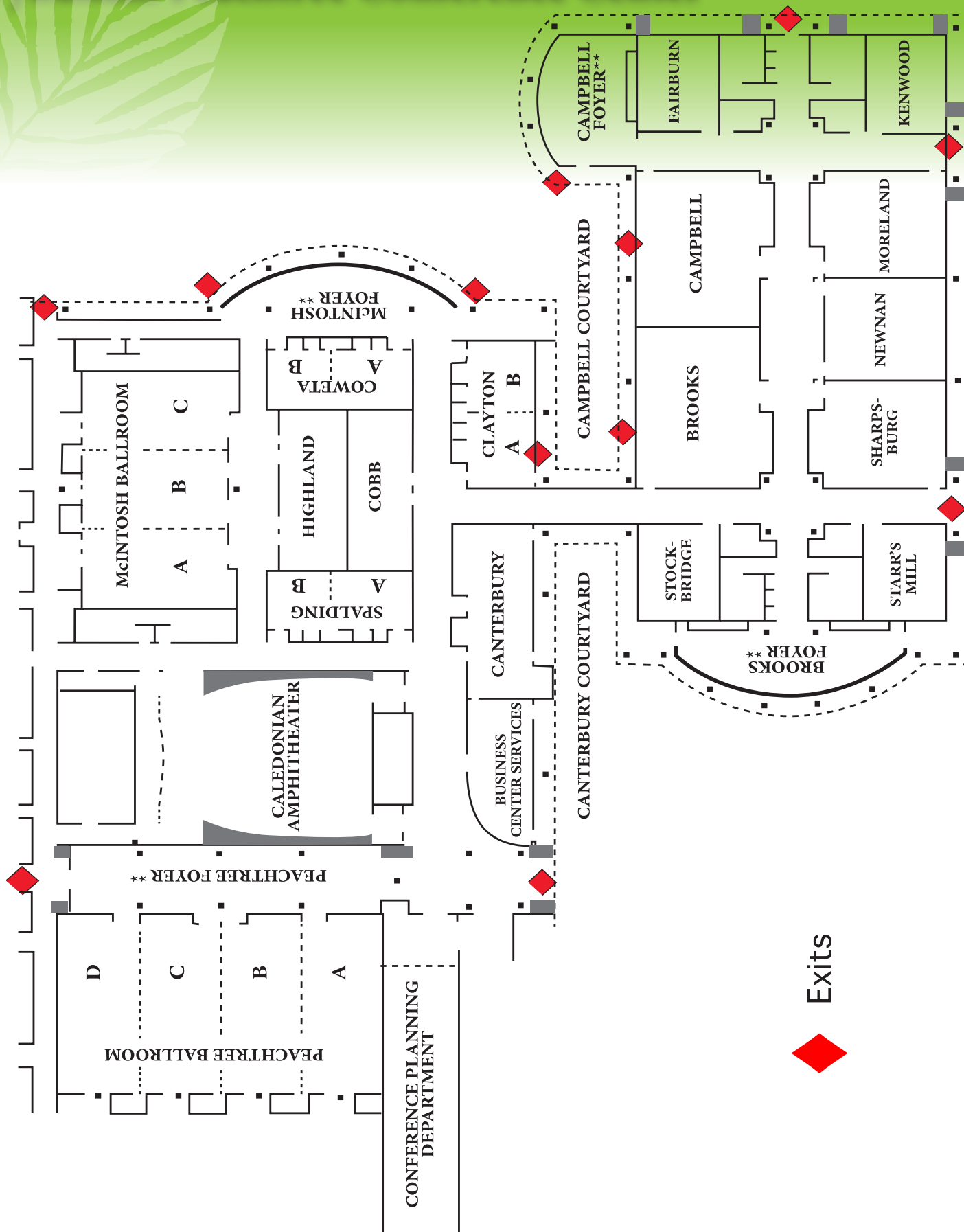

Capacity Chart

Room Name	Dim.	Sq. Ft.	Thtr.	Banq.	Class	U-ShapePods	Conf.	H-Sq.
Peachtree Ballroom	54' X 100'	5,400	600 / 450	450	400 / 250	N/A	252 / 175	N/A
Peachtree A, B, C, or D	54' X 25'	1,350	90 / 70	80	63 / 48	32 / 24	54 / 42	26 / 20
McIntosh Ballroom	46' X 70'	3,220	310 / 256	220	165 / 108	70 / 55	153 / 119	N/A
McIntosh A, B or C	46' X 23'	1,058	64 / 48	70	56 / 42	32 / 24	45 / 35	28 / 20
Coweta AB Spalding AB	18' X 43'	774	72 / 60	60	56 / 40	32 / 25	45 / 35	32 / 20
Coweta A or B Spalding A or B	18' X 21'	378	30 / 25	20 / 16	24 / 18	24 / 18	14 / 10	16 / 10
Highland	20' X 48'	960	66 / 55	60	64 / 56	30 / 23	45 / 35	28 / 20
Cobb	19' X 48'	960	66 / 55	60	64 / 56	30 / 23	45 / 35	28 / 20
Caledonian Amphitheater	N/A	3,000	-	-	230	-	-	-
Canterbury	25' X 54'	1,350	80 / 70	80	63 / 50	32 / 24	54 / 42	28 / 20
Clayton AB	22' X 44'	968	80 / 70	60	63 / 50	32 / 25	45 / 35	32 / 22
Clayton A or Clayton B	22' X 22'	484	35 / 30	20	24 / 18	14 / 10	18 / 14	16 / 10
Starr's Mill, Stockbridge, Fairburn or Kenwood	24' X 30'	720	65 / 48	50	43 / 35	24 / 18	36 / 28	26 / 18
Sharpsburg, Moreland & Newnan	37' X 30'	1,110	100 / 80	80	72 / 60	33 / 25	54 / 42	30 / 22
Campbell or Brooks	37' X 48'	1,776	150 / 115	120	112 / 88	44 / 33	72 / 56	35 / 26

• The capacity before the slash represents banquet chairs & banquet tables.
The capacity after the slash represents ergonomic chairs and hard writing surface tables.