



LOCATION

Wyndham DFW Airport North Hotel is located less than three miles from DFW Airport, ideally situated for business, meeting and leisure travelers alike. Our central location is convenient to area business complexes, restaurants, shopping and entertainment venues inclusive of: Grapevine Mills Mall, Grapevine Wineries, Texas Stadium, Six Flags over Texas and Lone Star Racetrack.

FEATURES

- Complimentary High Speed Wireless Internet in Guestrooms, Public Spaces and Event Space
- Outdoor Pool and Patio
- State of the Art Fitness Center with Dry Sauna
- 24 Hour Complimentary Airport Transportation

GUESTROOM INFORMATION

Number of Rooms.....	282
Number of Floors	8
Double Doubles.....	100
Kings.....	177
Suites	5

GUESTROOM FEATURES

- Be Well Bedding
- Cable, HBO and Pay-Per-View In-Room Movies
- Club Level Guestrooms and Hospitality Suites
- Coffeemaker and Hair Dryer
- Complimentary High Speed Wireless Internet
- Dual Line Telephones with Voicemail
- Full Size Iron and Ironing Board
- Individual Climate Control
- Michael Graves Designed Amenities
- MP3/Radio Alarm Clock
- Room Service
- True Blue Spa Bath Amenities
- Work Desk

GUEST SERVICES

- Wyndham ByRequest
- ATM
- Laundry/Valet
- Safety Deposit Boxes
- Sundries Available

DINING AND ENTERTAINMENT

- Flatland Grille, a contemporary Texas Bistro features an array of delectable Southwestern cuisine from Portabella and Brie Quesadillas to Cowboy Cut Bone-In Ribeye.
- Bar and Lounge
- Room Service

MEETING ROOM FEATURES

- 12,500 Square Feet of Flexible Meeting Space
- 12 total Meeting Rooms with banquet seating up to 500 and receptions up to 1,000
- 7,410 Square Foot Grand Ballroom
- Outdoor Poolside Event Area

MEETING SERVICES

- Exclusive Banquetology Concept, where Art and Science come together to Create the Perfect Dining Experience
- Creative CMP Packages, Menus and Signature Cocktails
- Complimentary High Speed Wireless Internet in Event Space
- Convenient Door to Door Airport Transportation for your Attendees
- Professional and Attentive Catering and Conference Service Team
- State of the Art Audiovisual Equipment Services

TRANSPORTATION

- 24 Hour Complimentary Airport and Five Mile Radius Transportation Available

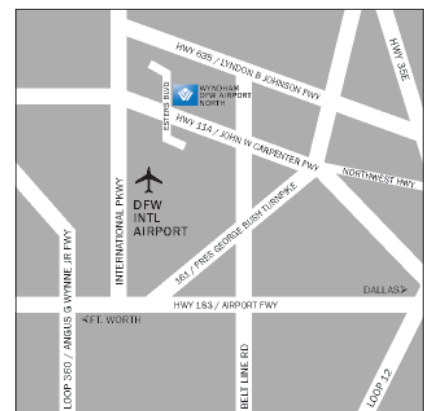

MEETING SPACE CAPACITY CHART

MEETING ROOM NAME	TOTAL SQ FT	DIMENSION	BANQUET	CLASSROOM	CONFERENCE	RECEPTION	THEATER	U-SHAPE
LINDBERGH GRAND BALLROOM	7,410	271 X 223	500	390	N/A	1,000	800	N/A
LINDBERGH I	1,813	37 X 49	75	100	48	120	160	48
LINDBERGH II	1,764	36 X 49	75	100	42	120	160	45
LINDBERGH III	504	28 X 18	20	20	20	35	30	15
LINDBERGH IV	504	28 X 18	20	20	20	35	30	15
ZEPPELIN	700	28 X 25	30	30	20	50	40	20
GALLAGHER	756	28 X 27	30	30	N/A	50	40	20
FOYER	1,369	37 X 37	60	N/A	N/A	90	N/A	N/A
WRIGHT	552	23 X 24	32	15	18	35	30	18
YEAGER	552	23 X 24	32	15	18	35	30	18
HUGHES	552	23 X 24	32	15	18	35	30	18
EARHART	1,330	38 X 35	80	60	32	75	130	32
ATRIUM	1764	36 X 49	110	N/A	N/A	125	N/A	N/A

CONFERENCE/MEETING ROOMS

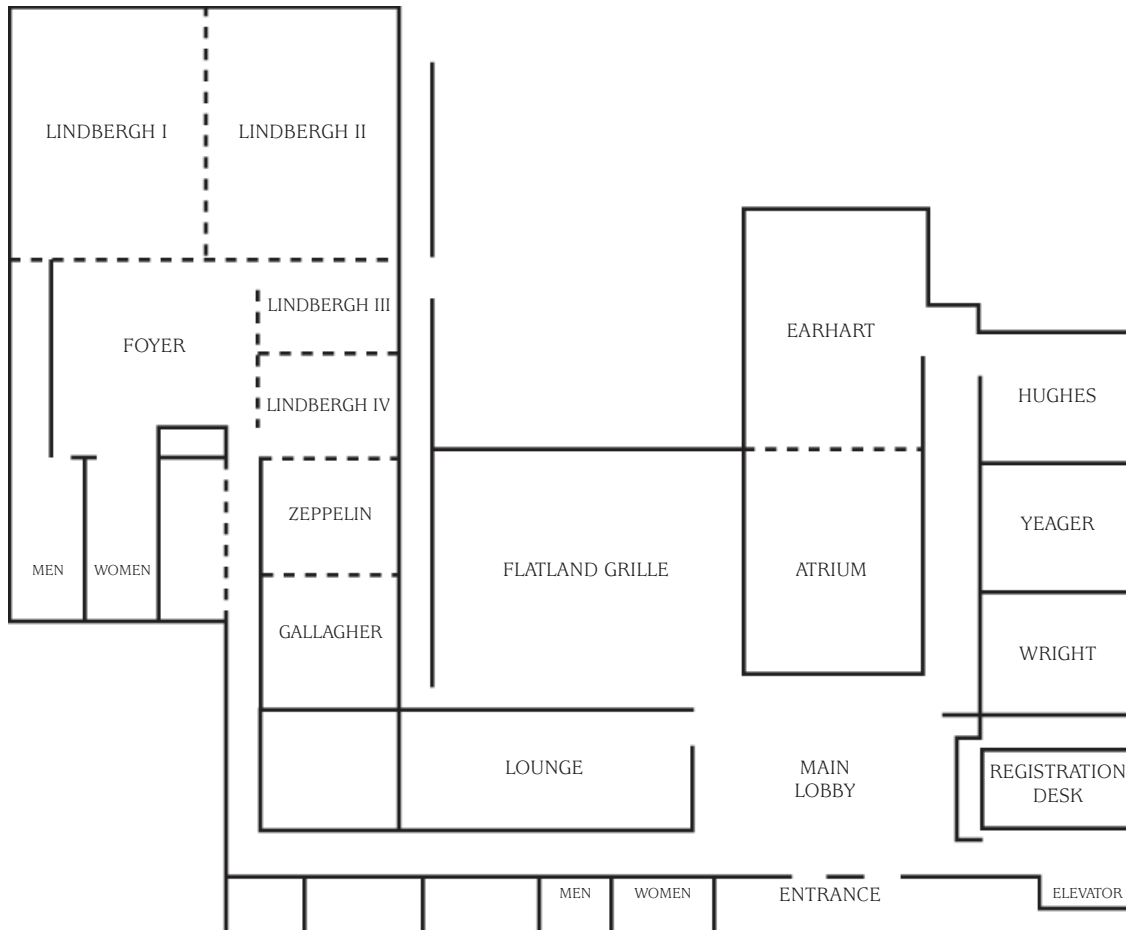

4441 West John Carpenter Freeway, Irving, Texas 75063 972-929-8181 Fax: 972-815-0262
www.wyndham.com

For individual reservations, call your travel planner or **800-WYNDHAM**.
For group sales, call **888-WYNDHAM**.
National Sales Offices: Atlanta, Chicago, Dallas, Northeast Region, Washington D.C., Western Region