

LOCATION

This Wyndham Hotel grasps the character and vibe of Southern California. Nestled on a serene lakeside, this boutique-style hotel is the essence of elegance, privacy, and comfort, yet it is in the heart Orange County's Corporate and Cultural Center. Across from the Orange County Performing Arts Center, walking distance to South Coast Plaza, and only miles away from famous beaches, the blissful Wyndham Orange County will have you beckoning for more.

FEATURES

- 100% Smoke-free
- Attractive, comfortable guest rooms detailed for the business and leisure traveler
- Total 238 guest rooms and Suites
- Complete banquet facilities
- Restaurant and lounge
- Covered parking
- Year-round heated outdoor pool and whirlpool
- Jogging trails and onsite fitness room
- Helpful, courteous, and knowledgeable associates
- Peaceful lake with walking path
- Valet laundry and dry cleaning
- Lobby work station with high speed Internet and print capabilities
- Pet Friendly
- Complimentary shuttle service to and from John Wayne Airport

ROOM DETAILS

- Working Desks with ergonomic chair
- Walk-out balconies
- Wired & wireless Internet access
- Flat Screen TV with cable & in-room movies
- ADA accessible rooms
- Bath & Body Works® True Blue® Spa amenities
- Iron and ironing board
- Coffee maker
- Refrigerator
- iPod docking & alarm station
- Secure, computerized card-key lock

DINING AND ENTERTAINMENT

- Enjoy fresh California & Italian fare featuring char-grilled meats and seafood. Dine al fresco and enjoy the lakeside ambiance
- Serving breakfast, lunch, and dinner
- A warm and inviting lobby lounge
- In-room dining
- High Speed Wireless Internet available in TerraNova and lounge

ATTRACTIONS

- Orange County Performing Arts Center
- Renee & Henry Segerstrom Concert Hall
- South Coast Repetory Theatre
- South Coast Plaza
- The Spa at South Coast
- Famous beaches
- Angel Stadium/Honda Center
- Disneyland/Knotts Berry Farm

MEETING SPACE HIGHLIGHTS

- Experienced Meeting Managers
- Creative social events
- Meeting Packages designed to fit your needs
- 8 separate meeting rooms
- State-of-the-art technical capabilities
- Over 7,200 square feet of interior, flexible meeting space
- 8,000 square feet of outdoor lakeside area available for special events
- The Ballroom has 3,456 square feet with 16' high ceilings
- Banquets for groups up to 250
- Receptions for up to 375
- Spacious prefunction areas

GETTING THERE

From John Wayne / Orange County Airport (SNA)
Distance : 3 miles. From airport, follow signs to the 405 North Freeway. Take exit 9B toward Bristol Street. Keep right at the fork, follow signs for Ave of the Arts/Anton Blvd and merge onto Ave of the Arts. Hotel will be on your right.

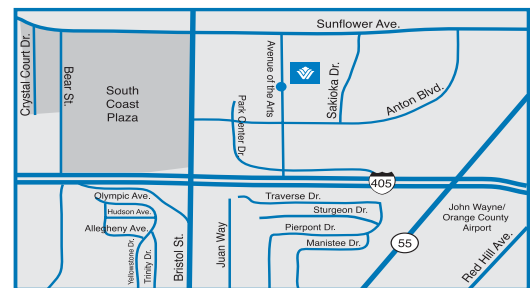

MEETING SPACE CAPACITY CHART

| Name Of Room | Dimensions | Square Feet | Theater | Classroom | Banquet | Reception | Conference | U-shape |
|---------------------|-------------|-------------|---------|-----------|---------|-----------|------------|---------|
| Grand Ballroom | 48'x72'x16' | 3,456 | 380 | 225 | 250 | 375 | 150 | 100 |
| Salons A, B or C | 48'x24'x16' | 1,152 | 110 | 70 | 80 | 110 | 45 | 40 |
| The Ballroom Foyer | -- | 1,200 | -- | -- | -- | 110 | -- | -- |
| The Garden Room | 43'x28'x12' | 1,204 | 125 | 85 | 90 | 110 | 45 | 40 |
| The Board Room | 29'x14'x10' | 406 | -- | -- | 15 | -- | 15 | -- |
| The California Room | 28'x29'x30' | 812 | 90 | 40 | 60 | 70 | 30 | 25 |
| The Costa Mesa Room | 12'x14'x10' | 168 | -- | -- | 10 | -- | 10 | -- |
| Terranova | -- | -- | -- | -- | 140 | -- | -- | -- |

*Our meeting room capacities have been calculated using the Meeting Professional International Comfort Calculator

FLOOR PLAN CHART

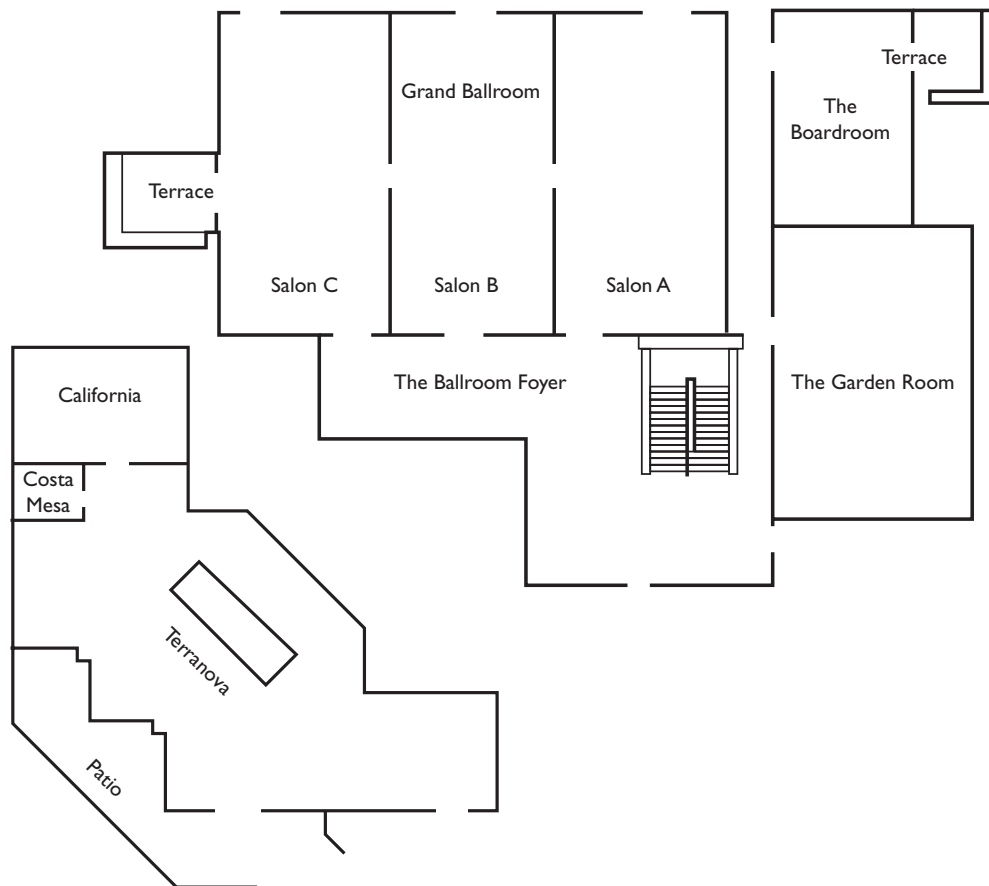

3350 Avenue of the Arts, Costa Mesa, California 92626 Phone: 714-751-5100 Fax: 714-751-2704

800-WYNDHAM / wyndham.com Group Sales: 888-WYNDHAM